

HX1080 Series Expanded Beam



The HX-1080 series HD & SD TV connectors offer a rugged expanded beam connector for hybrid fibre/electrical duty. Backed by more than 25 years experience with expanded beam fibre connector technology, these connectors offer a non contact, easy to clean lensed fibre alternative to traditional broadcast connectivity.

In support of the deployment of HDTV and progressing from the limitations of legacy fibre contacting connector interfaces, Stratos has drawn on its unique experience for the development of the HX-1080 Broadcast Series. With world leading single mode EB optical performance using protected lensed fibres, the Stratos HX-1080 is designed to meet and exceed the generic requirements of the SMPTE specifications.

On cameras at Studio or OB locations, Stratos HX-1080 Series connectors provide a solution that will work first time and every time. Offering unrivalled performance and versatility with low cost de-skilled field re-instatement solutions, and World-Wide support to HX-1080 are now set to become the new bench-mark for hybrid connectors in the challenging Broadcast environment.

Applications

- SD Tv and HD Tv Cameras
- Broadcast networks
- Signalling and data transmission
- Remote power
- Hybrid fibre, copper networks

Features & Benefits

- Rugged hermaphroditic design allows for daisy chaining & removes requirements for adapters or male and female connectors
- SMPTE compatible for true broadcast network interoperability
- Flexible install options with plug and bulkhead mount options
- Ergonomic easy to handle design
- High performance low loss fibre connections
- Easy to clean lensed interface, simple wipe contaminates away
- Non-contact optics ensure no degradation of links over time
- High reliability/durability due to non contact interface and rugged IP67 sealing
- Swappable coloured rubber rings on plugs and bulkheads allow for quick link identification

Technical Specifications

Insertion loss	50/125 @ 850/1300nm ≤ 1.2 dB 9/125 @ 1310/1550nm ≤ 1.5 dB
Return loss	9/125 @ 1310/1550nm > 45 dB
Operating temperature	-40 to +85°C
Storage temperature	-55 to +85°C
Connector endurance	> 2000 mating cycles
Free fall resistance	500 falls onto concrete from 1.2M height
Crush resistance	> 3000 N
Tensile strength	Tensile of 1000N, cable dependent
Environmental protection	Rugged extruded rubber shell and included extruded plastic dust cap
Electrical connectors	2 cores 20AWG
Signal connectors	2 cores 24AWG

Connector Geometry & End Face Arrangement

HX1080 Series Plug

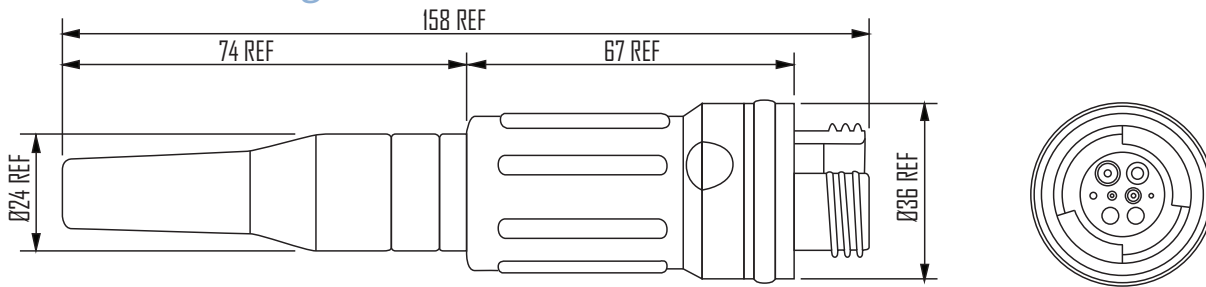

HX1080 Series Flange Mount Bulkhead

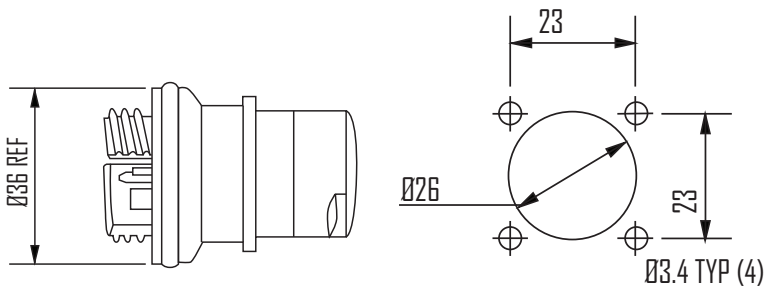

Note: All dimensions are in mm

Active | Passive | Test Equipment | Tooling | Cable | Fibre Management

For further information:
www.fibreoptic.com.au
 +61 3 9757 3000

Page 2 of 2

FOS
 Fibre Optic Systems