

Schill Field Deployable Cable Reels



Field deployable cable reels offer a convenient method for roll-out and retrieval of fibre optic cable assemblies as well as a range of communications cabling. FOS offers a range of cable reels in variety of sizes and constructions.

Hand wound reels offer a simple deployment and retrieval method that allows for patching of cable assemblies without the need to fully unwind the reel. These reels are well suited to the FOS range of harsh environment cable assemblies including: expanded beam, multi channel physical contact and broadcast connectivity.

Applications

- Broadcast and television networks
- Defence deployable communications
- Mine site and harsh environment cabling
- Deployable connectivity

Features & Benefits

- Ruggedised and lightweight, specialised rubber/plastic compound offers excellent handling and protection of cable and assemblies (excludes HT series)
- Steel sheet construction for all HT series reels offers excellent environmental and mechanical properties
- Auxiliary flange design offers convenient access to both ends of the cable or assembly
- Available with or without cable or cable assembly
- Integrated folding handle offers convenient winding and storage

Technical Specifications

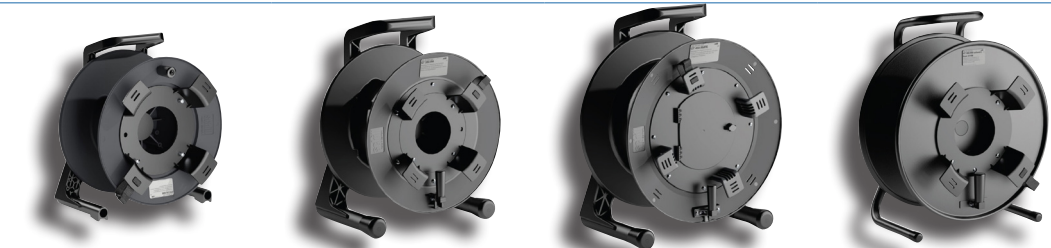
Part Number	SCHILL-GT310	SCHILL-GT380	SCHILL-GT450	SCHILL-HT380
Description	Schill Field Deployable Cable Reel - 310mm Plastic	Schill Field Deployable Cable Reel - 380mm Plastic	Schill Field Deployable Cable Reel - 450mm Plastic	Schill Field Deployable Cable Reel - 380mm Steel
Material	Ruggedised Rubber/Plastic	Ruggedised Rubber/Plastic	Ruggedised Rubber/Plastic	Ruggedised Steel
Weight (kg) unloaded	1.8	4.3	5.6	5.3
Cable capacity est. (m)	160 @ 6mm OD	290 @ 6mm OD	365 @ 6mm OD	300 @ 6mm OD
Dimensions (mm) WxHxD	310 x 367 x 230	380 x 491 x 291	445 x 555 x 312	380 x 450 x 241
Specific dimensions (mm)	A: 310 B: 170 C: 132 D: 263 E: 180 F: 367 G: 230	A: 380 B: 236 C: 182 D: 310 E: 235 F: 491 G: 291	A: 445 B: 296 C: 187 D: 345 E: 266 F: 555 G: 312	A: 380 B: 178 C: 141 D: 300 E: 210 F: 450 G: 241
Reference image				

Reference Drawing

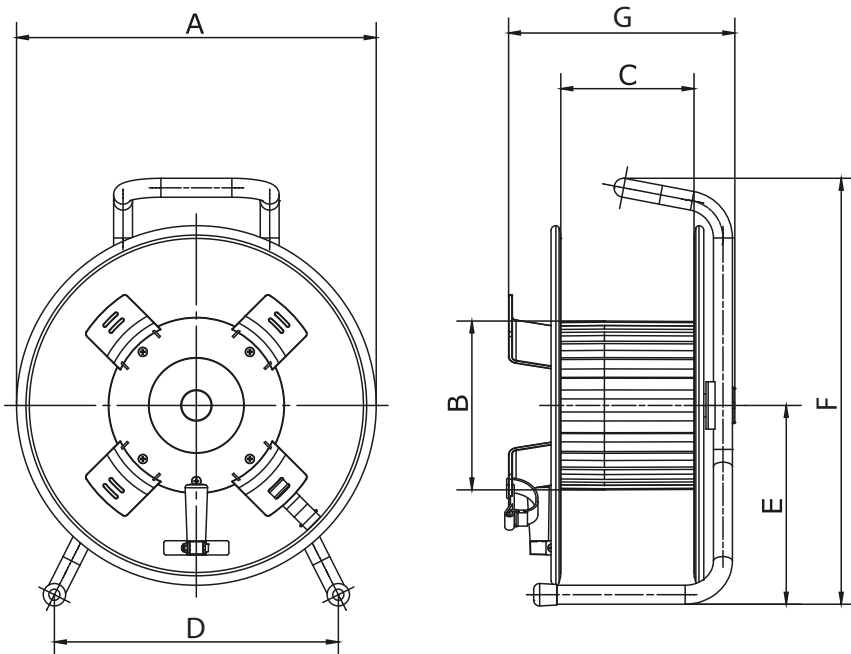

Active | Passive | Test Equipment | Tooling | Cable | Fibre Management

For further information:
www.fibreoptic.com.au
 +61 3 9757 3000

Page 2 of 2

FOS
 Fibre Optic Systems