

S900 Series Expanded Beam



The S900 Series harsh environment connectors are designed for deployment in the toughest applications where high performance and total reliability are critical. Benefiting from Stratos expanded beam technology, with a long and proven industry track record, the precision optical alignment system creates immunity from water, mud, dust, oil, and other contaminants which normally ingress the optical path and rapidly deteriorate performance in a field environment.

Ideally suited in environmental extremities where low maintenance necessary. A variety of shell materials make the 900 Series suitable for use in extreme sub-zero & marine environments through to military platforms used in the most hostile of desert conditions.

The 900 Series Expanded Beam Fiber Optic Connectors deliver a proven pedigree and world beating capability.

Applications

- Particularly suited to marine environments
- Military communications
- Industrial, mining and petrochemical
- Desert, sub-zero & underground environments

Features & Benefits

- Advanced expanded beam technology
- The 900 Series Hermaphroditic design eliminates the need for adapters and male and female mating halves
- 2 or 4 fibre low loss single mode, multimode, or hybrid daisy chained links
- Multiple wavelength capability
- Rugged field repairable connector design
- Best optical performance available
- No adapters necessary
- Operational flexibility
- Durable and field proven
- Low downtime field repair
- Nickel Aluminum Bronze for marine environments

Active | Passive | Test Equipment | Tooling | Cable | Fibre Management

For further information:
www.fibreoptic.com.au
+61 3 9757 3000

Technical Specifications

Insertion loss	50/125 @ 850/1300nm 0.8 dB typ 9/125 @ 1310/1550nm 1.0 dB typ
Return loss	9/125 @ 1310/1550nm >45dB (typical 48dB)
Operating temperature	-40 to +70°C
Storage temperature	-55 to +85°C
Water immersion	up to 2M depth
Vibration sinusoidal	10-500Hz, 0.75 amplitude @ 10g acceleration
Free fall resistance	500 falls onto concrete from 1.2M height
Bump resistance	4000 bumps @ 40g acceleration
Tensile strength	Tensile of 2000N, cable dependent
Environmental protection	Rugged extruded rubber shell and included dust cap

Connector Geometry & End Face Arrangement

S900 Series Plug

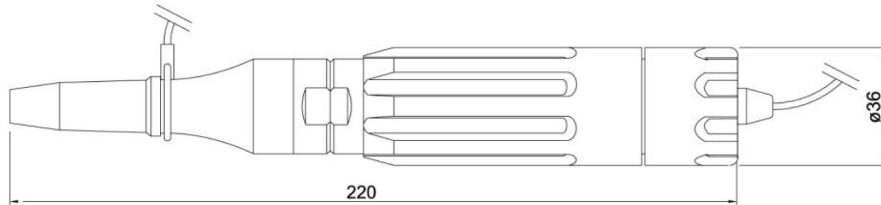

Channel Arrangement

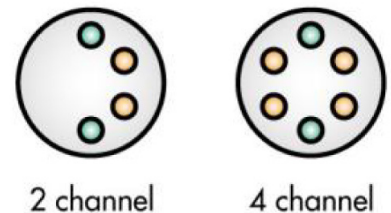

2 channel

4 channel

S900 Series Jam Nut Bulkhead

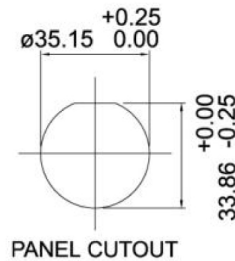
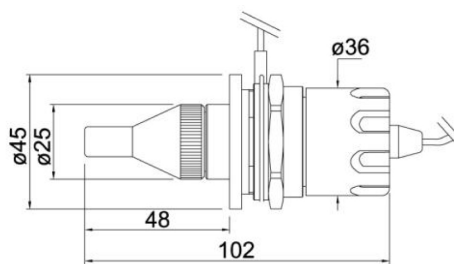

S900 Series Flange Mount Bulkhead

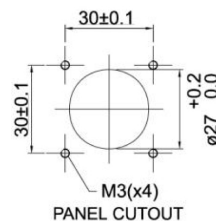
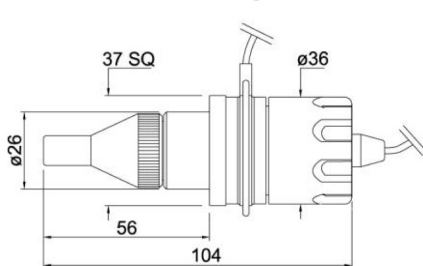

Note: All dimensions are in mm

Active | Passive | Test Equipment | Tooling | Cable | Fibre Management

For further information:
www.fibreoptic.com.au
 +61 3 9757 3000

Page 2 of 2

FOS
 Fibre Optic Systems